

|          |  |
|----------|--|
| CONCRETE | REINFORCED CONCRETE SLAB TO STRUCTURAL ENGINEERS DETAILS         |
| TILES    | FLOOR TILES TO SELECTION   |
| PAVING   | CONCRETE PAVING WITH EXPOSED AGGREGATE TO MATCH EXISTING         |
| D1.6     | DOOR / APARTMENT NO. / DOOR NO. G - GROUND LEVEL F - FIRE STRIKE |
| W1.2     | WINDOW / APARTMENT NO. / WIND. NO.                               |
| GB       | GARDEN BED. PROVIDE IRRIGATION TO CIVIL ENGINEERS DETAILS        |
| PL       | PLANTER BOX. PROVIDE IRRIGATION TO CIVIL ENGINEERS DETAILS       |
| WS       | CONCRETE WHEEL STOP TO CIVIL ENGINEERS DETAILS                   |
| DP       | DUMP - REFER ROOF SCHEDULE                                       |
| GS       | GRADED SUMP TO CIVIL ENGINEERS DETAILS                           |
| S        | SUMP TO CIVIL ENGINEERS DETAILS                                  |
| SD       | PROPRIETARY STRIP DRAIN TO CIVIL ENGINEERS DETAILS               |
| FT       | FLOOR TRAP TO CIVIL ENGINEERS DET                                |
| SS       | SEWER STACK PIPE TO HYDRAULIC CONSULTANTS DETAILS                |
| COL      | STRUCTURAL COLUMN TO ENGINEERS DETAILS                           |

|      |   |
|------|---|
| ZKL  | ZINCALUME KLIP-LOCK 700 HI STRENGTH<br>0.48 MTB ROOF SHEETING FIXED TO<br>STEEL ROOF STRUCTURE TO<br>MANUFACTURERS DETAIL.                          |
| CKL  | COLORBOND KLIP-LOCK 700 HI STRENGTH<br>0.48 MTB ROOF SHEETING - AS ABOVE  |
| DP   | 900 PVC DOWNPIPE TO HYDRAULIC<br>SERVICES CONSULTANTS DETAILS.  |
| DP1  | 1000 S/G PVC DOWNPIPE TO HYDRAULIC<br>SERVICES CONSULTANTS DETAILS.<br>REFER TO CIVIL ENGINEERING DRAWINGS<br>FOR STORMWATER CONNECTION<br>DETAILS. |
| DP2  | 1500 S/G PVC DOWNPIPE TO HYDRAULIC<br>SERVICES CONSULTANTS DETAILS.<br>REFER TO CIVIL ENGINEERING DRAWINGS<br>FOR STORMWATER CONNECTION<br>DETAILS. |
| DP3  | 500 S/G PVC DOWNPIPE CONCEALED IN<br>WALL AND FLOOR. CONNECT TO<br>STORMWATER SYSTEM TO HYDRAULIC<br>SERVICES CONSULTANTS DETAILS.                  |
| B-G1 | 450 x 150MM ZINCALUME BOX GUTTER<br>ON SPANDEK GUTTER BOARD AND ADJ.<br>STRAPS @ 900MM MAX. CTS.  |
| B-G2 | 450 x 120MM ZINCALUME BOX GUTTER<br>ON SPANDEK GUTTER BOARD AND ADJ.<br>STRAPS @ 900MM MAX. CTS.  |
| B-G3 | 300 x 120MM ZINCALUME BOX GUTTER<br>ON SPANDEK GUTTER BOARD AND ADJ.<br>STRAPS @ 900MM MAX. CTS.  |
| B-G4 | 500 x 100MM ZINCALUME BOX GUTTER<br>ON SPANDEK GUTTER BOARD AND ADJ.<br>STRAPS @ 900MM MAX. CTS.  |

|       |  |
|-------|--|
| EJ    | EXPANSION JOINT IN BOX GUTTER  |
| FJ    | 750 OVERFLOW P/V PIPE  |
| GS    | PROPRIETARY GUTTA STOP WITH LEAF GUARD INSTALLED TO MANUFACTURERS SPECIFICATION. LOW PROFILE WHERE REQUIRED. |
| S     | 50MM SETDOWN TO BOX GUTTER AT OUTLET LOCATIONS   |
| RAH   | 1000/800MM ROOF ACCESS HATCH WITH TWO STRUTS COMPLETE WITH ALUMINIUM FRAMED FOLD DOWN STEP LIFT AS SPECIFIED |
| BL    | ALUMINIUM FRAMED BALUSTRADE AS DETAILED  |
| RW    | REINFORCED FIBRE ROOF WALKWAYS AS SPECIFIED.   |
| SL    | STATIC LINE FALL ARREST SYSTEM AS SPECIFIED (CORRECT SAFETY OF EQUAL)  |
| AP    | ANCHOR POINT FALL ARREST SYSTEM AS SPECIFIED (CORRECT SAFETY OF EQUAL)                                       |
| CS    | COLORBOND SLAT SCREENS AS SPECIFIED  |
| CC    | COLORBOND PARAPET CAPPING  |
| CF    | COLORBOND FLASHING   |
| ZF    | ZINCALUME FLASHING   |
| S.COL | STEEL STUB TO ENGINEERS DETAILS. DETKITE WEATHERSEALS TO ROOF PENETRATIONS.                                  |
| P     | POWDERCOATED STEEL POST TO ENGINEERS DETAILS.  |

**W1**     **STUD FRAMED PLASTER BOARD**  
-90/90 FRL - DOUBLE 64MM STEEL STUD  
FRAMING = 64mm CHANNEL WITH 1 LAYER OF  
16mm FYRCHEK & 1 LAYER 13mm FLUSHED AND  
PAINTED PLASTERBOARD LINING TO  
MATCH FINISHES OF PLASTERBOARD EXTENDING  
TO UNDERSIDE OF SLAB OVER AS DETAILLED.  
7.5MM BLUEBOARD WITH 3 LAYER ACRADEX  
FINISHES EXTERNALLY AS DETAILED.

**W2**     **LONGLINE / HEBEL POWERPANEL XL WALL**  
-90/90 FRL - COLORBOND LONGLINE 305  
CLADDING TO 75mm THICK HEBEL PANEL ON  
FURRING CHANNELS TO 92mm STEEL STUD  
FRAMING. 2 LAYER 13mm THICK FLUSHED AND  
PAINTED FIRE RATED PLASTERBOARD  
INTERNALLY AS DETAILED.

**W3**     **STUD FRAMED INTERNAL WALL**  
-64mm STEEL STUD FRAMING WITH 13mm THICK  
FLUSHED AND PAINTED PLASTERBOARD  
LINING TO BOTH SIDES AS DETAILED.

**W4**     **HEBEL POWERPANEL XL WALL**  
-90/90 FRL - 75mm THICK HEBEL PANEL WITH  
3 LAYER ACRADEX 13mm THICK FLUSHED AND  
PAINTED FURRING CHANNELS TO 92mm STEEL  
FRAMING. 2 LAYER 13mm THICK FLUSHED AND  
PAINTED FIRE RATED PLASTERBOARD  
INTERNALLY AS DETAILED.  
A = 2 ROWS 92mm STEEL STUD FRAMING  
B = 1 ROW 13mm STEEL STUD FRAMING

**W5**     **STUD FRAMED EXTERNAL WALL**  
-90/60 FRL - 1 LAYER 7.5mm THICK BLUEBOARD  
OVER 1 LAYER 16mm THICK FYRCHEK  
EXTERNALLY FIXED TO 92mm STEEL STUD  
FRAMING WITH 3 LAYER 13mm THICK FLUSHED  
2 LAYER 13mm THICK FLUSHED AND PAINTED  
SOUND / LINDSEY CONCRETE PANELS AS DETAILED

**W6**     **150 / 125mm PRECAST CONCRETE PANELS**  
-90/60 FRL - PRECAST CONCRETE PANELS TO  
ENGINEER'S DETAILS. PAINT FINISH TO  
EXPOSED FACES AS SPECIFIED  
A - CONCRETE KINGSSPAN K5 RIGID INSULATION  
BOARD

**W7**     **BLOCK WALL**  
140mm THICK HOLLOW OR CORE FILLED  
BLOCKWORK TO ENGINEERS DETAILS.  
1 LAYER ACRADEX 13mm THICK FLUSHED AND  
WATERPROOF TANKING FINISH AS  
SPECIFIED. ALSO REFER FINISHES.

**W8**     **GOOD NEIGHBOUR FENCE**  
1500mm HIGH ALUMINIUM FINISH, CUSTOM ORB  
COLORBOND GOOD NEIGHBOUR FENCE ON  
CONCRETE SLEEPERS AS REQUIRED TO  
ENGINEERS DETAIL. REFERENCE TO  
MANUFACTURERS SPECIFICATION.

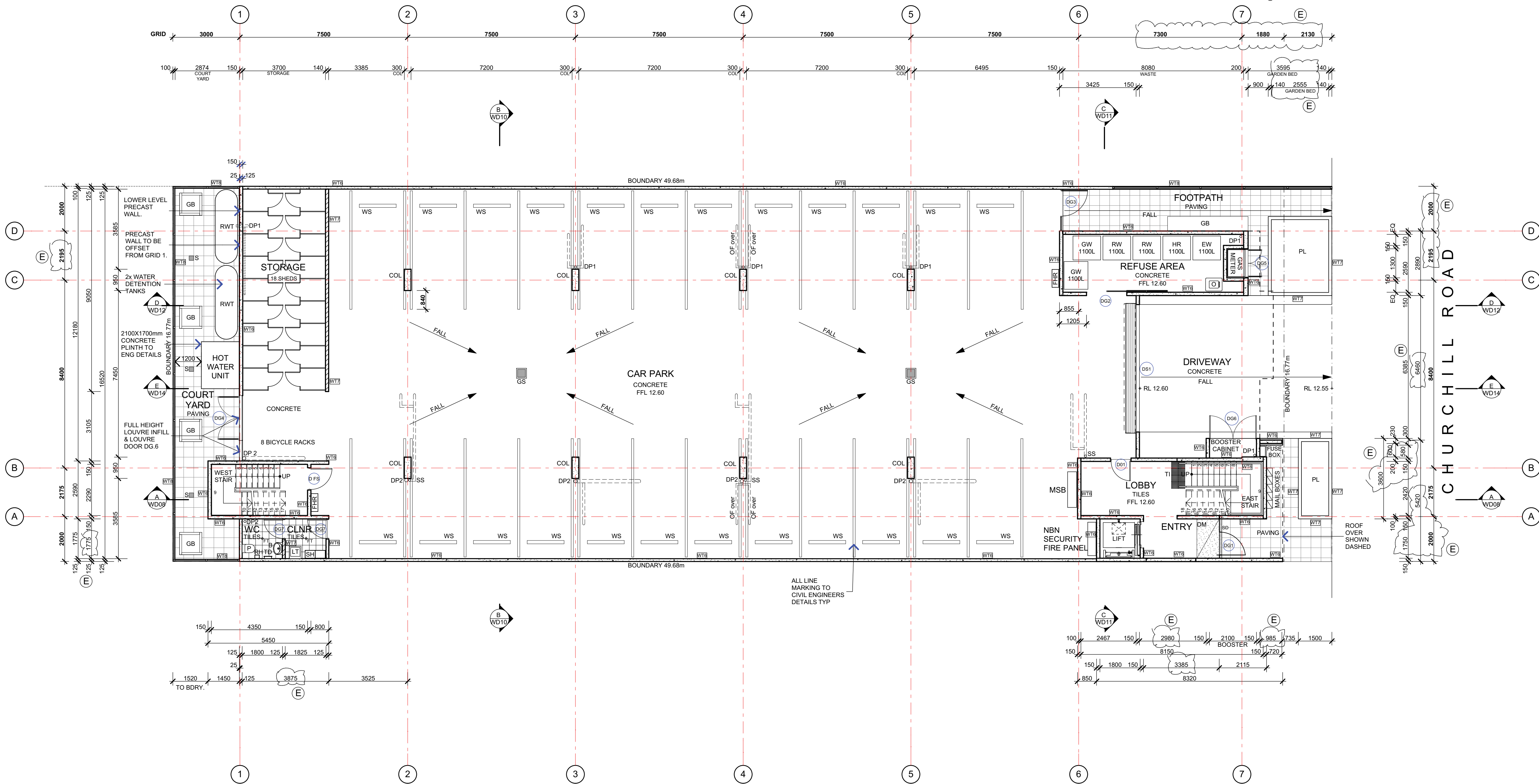

**SITE/GROUND FLOOR PLAN**  
1:100 A1  
1:200 A3

|   |            |   |
|---|------------|---|
| E | 24.02.2017 | DIMENSIONS CLARIFIED AS CLOUDED   |
| D | 29.11.2016 | FIRE HYDRANTS IN EAST + WEST STAIRS<br>RELOCATED AND DELETED FROM VIEW<br>ON GROUND LEVEL |
| C | 18.11.2016 | ISSUED FOR CONSTRUCTION   |
| B | 12.10.2016 | SANITARY FACILITIES ADDED   |
| A | 16.09.2016 | ISSUED FOR BUILDING RULES CONSENT   |



Architecture  
Interior design  
Project Management

11 Eliza St. Adelaide SA 5000  
P +618 8231 4434  
F +618 8211 7701  
E [nelson@nelsonarchitects.com.au](mailto:nelson@nelsonarchitects.com.au)

|         |   |
|---------|---|
| Project | 130 CHURCHILL RD APARTMENTS<br>130 Churchill Road<br>Prospect SA 5082 |
|---------|---|

Drawing Title

---

GROUND FLOOR PLAN

|                |               |          |
|----------------|---------------|----------|
| Drawn          | Checked       | Scale    |
| JG JS          | JN            | As Shown |
| Date Created   | CAD File Name |          |
| 22.07.16       | 02130 WD      |          |
| Drawing Number | Issue         |          |
| 02130 WD01     | E             |          |

Copyright of design and drawings are reserved. The contractor shall verify all dimensions and levels before commencing any works or shop drawings. Refer any discrepancies to the Architect. A printed copy of this drawing may not be to scale.  
A.C.N. 008 215 558

Nelson Architects Pty Ltd